

Barn Shaped Bookshelf



Difficulty: **Intermediate**

Free plans to build a barn shaped bookshelf - perfect for your farm themed children's room! Our step by step plans include diagrams, shopping and cut list, and lots of reader submitted photos.

Reader submitted photo by HARBERBUILDERS (<https://www.ana-white.com/community-projects/barn-dollhouse-0>)

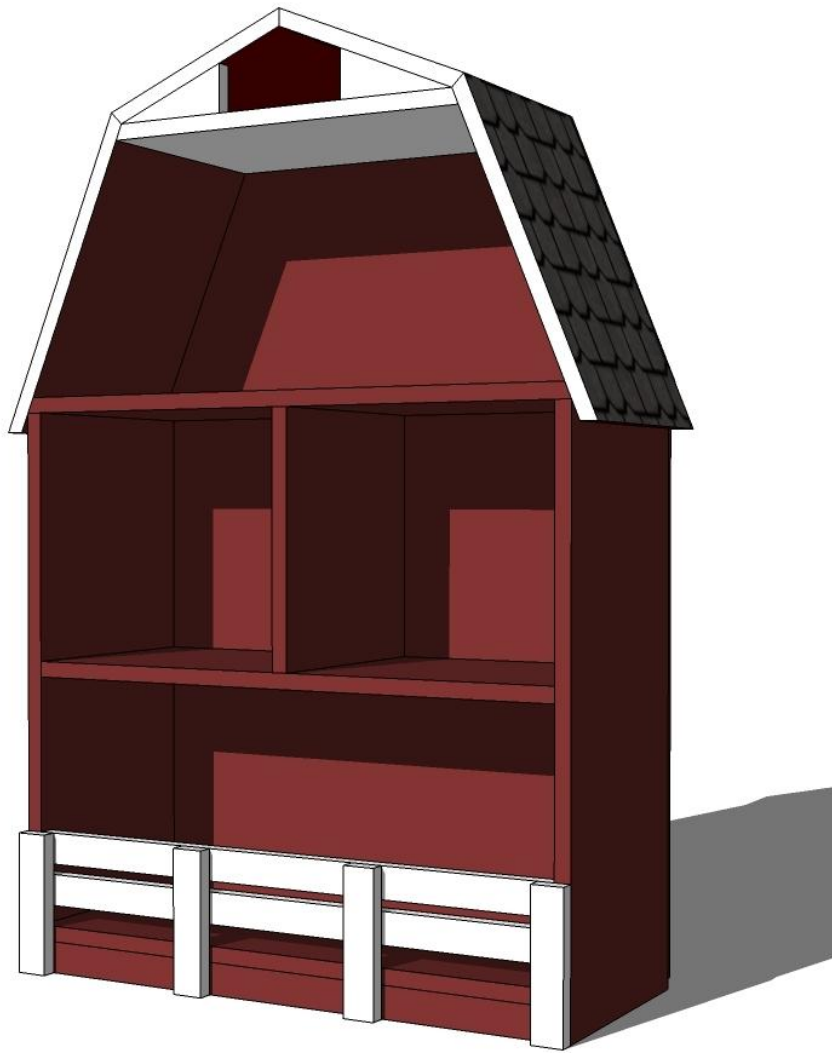

Complete with a barn style roof, three large shelves, and a stuffed animal coral, this barn bookshelf is perfect for your farm loving little one! You'll need a miter saw that bevels to 22 1/2 degrees to pull off those roof angles, or a circular saw with a blade that bevels. Other than that, this one is pretty easy to build!

Dimensions

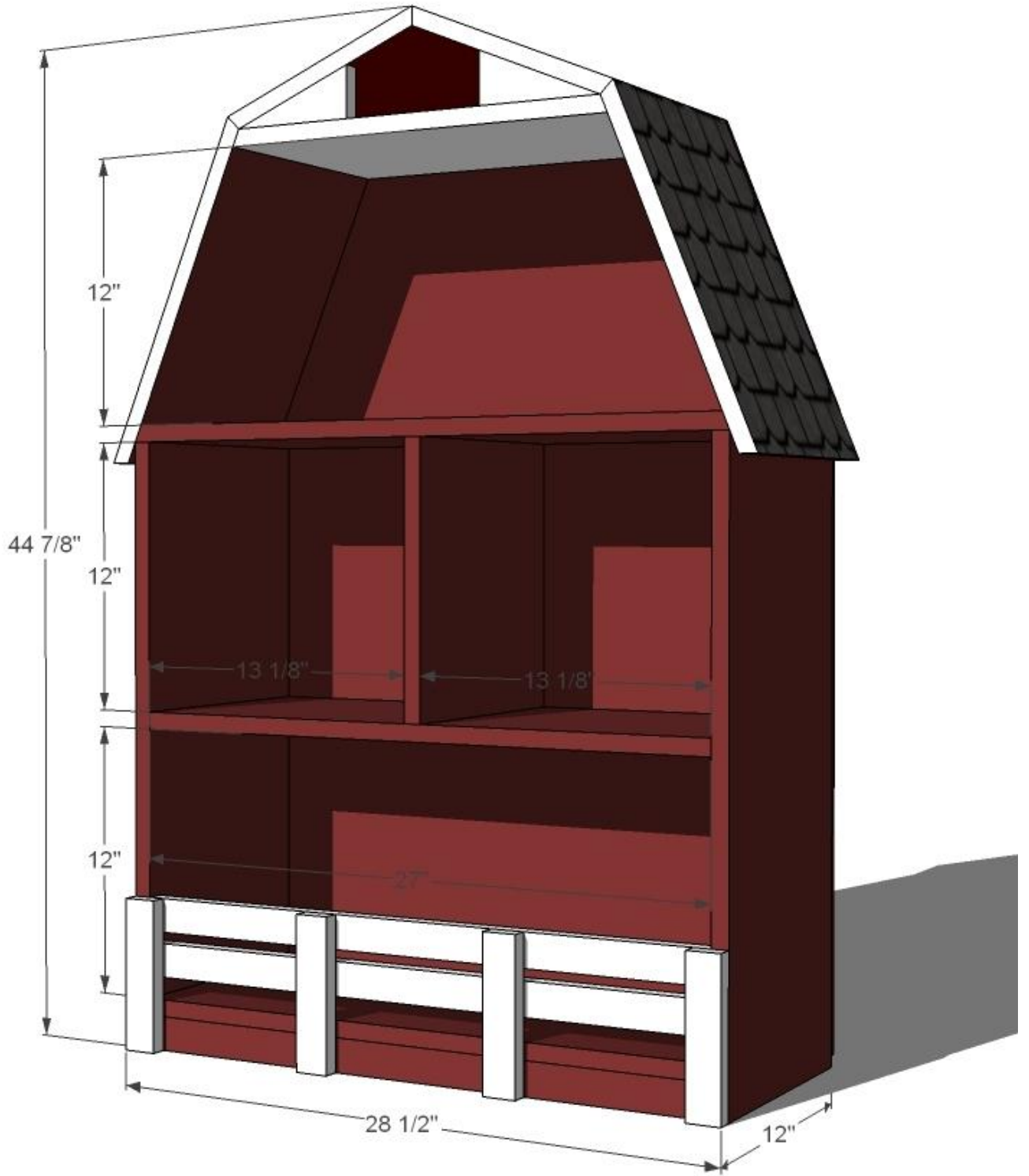

Dimensions shown above

Preparation

SHOPPING LIST

- 3 - 1x12 @ 8 feet long
- 2 - 1x2 @ 8 feet long
- 6" of 1x6 scraps
- 1/2 sheet of 1/4" plywood for back

COMMON MATERIALS

2 inch screws

1 1/4 inch finish nails

1-1/4" Pocket Hole Screws

([http://www.amazon.com/gp/product/B0006444U2/ref=as_li_tl?](http://www.amazon.com/gp/product/B0006444U2/ref=as_li_tl?ie=UTF8&camp=1789&creative=390957&creativeASIN=B0006444U2&linkCode=as2&tag=know20&linkId=5AJJGUAWGYX2TT7E)

[ie=UTF8&camp=1789&creative=390957&creativeASIN=B0006444U2&linkCode=as2&tag=know20&linkId=5AJJGUAWGYX2TT7E\)](http://www.amazon.com/gp/product/B0006444U2/ref=as_li_tl?ie=UTF8&camp=1789&creative=390957&creativeASIN=B0006444U2&linkCode=as2&tag=know20&linkId=5AJJGUAWGYX2TT7E)

CUT LIST

- 4 - 1x12 @ 27" (shelves and sides)
- 1 - 1x12 @ 12" (divider)
- 1 - 1x12 @ 28 1/2" - both ends BEVELED at 22 1/2 degrees off square, long point to long point, ends NOT parallel (middle floor)
- 1 - 1x2 @ 27" (footer)
- 2 - 1x12 @ 16 1/4" - both ends beveled at 22 1/2 degrees off square, long point to long point, ends NOT parallel (lower roof)
- 1 - 1x12 @ 18" - both ends beveled at 22 1/2 degrees off square, long point to long point, ends NOT parallel (loft floor)
- 2 - 1x12 @ 10" - both ends beveled at 22 1/2 degrees off square, long point to long point, ends NOT parallel (upper roof)
- 2 - 1x6 @ 2 1/4" long point, cut at 22 1/2 degrees off square (optional loft siding)
- Back plywood is 45" x 28 1/2" overall.
- FENCE 2 - 1x2 @ 27" 4 - 1x2 @ 6 3/4"

TOOLS



Tape Measure



Speed Square



Pencil



Safety Glasses



Ear Protection



Kreg Jig



Drill



Miter Saw



Brad Nailer



Sander



Drill Bit Set

GENERAL INSTRUCTIONS

Please read through the entire plan and all comments before beginning this project. It is also advisable to review the Getting Started Section. Take all necessary precautions to build safely and smartly. Work on a clean level surface, free of imperfections or debris. Always use straight boards. Check for square after each step. Always predrill holes before attaching with screws. Use glue with finish nails for a stronger hold. Wipe excess glue off bare wood for stained projects, as dried glue will not take stain. Be safe, have fun, and ask for help if you need it. Good luck!

Instructions

STEP 1

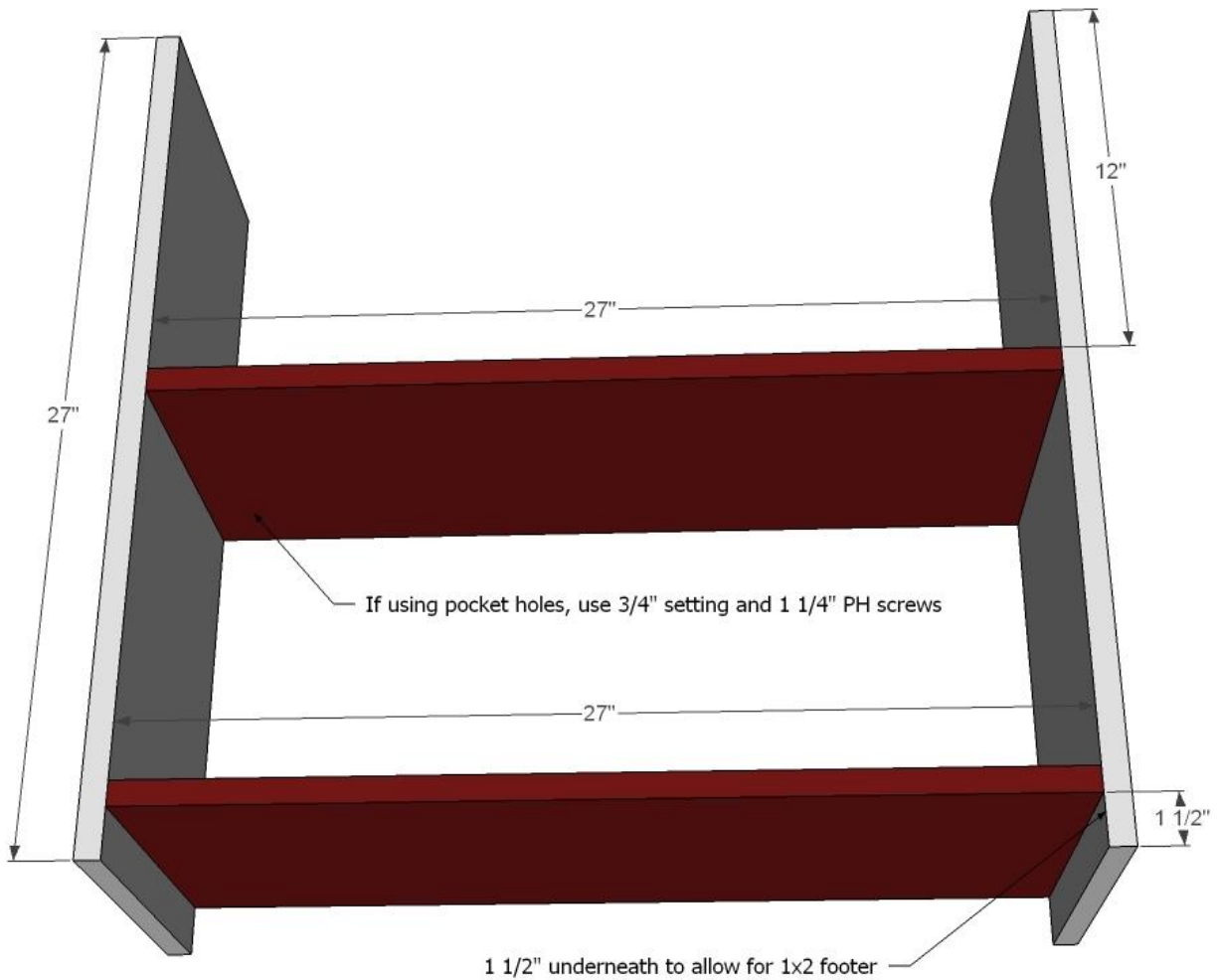

(/sites/default/files/3154817738_1353356808.jpg)

Start by building the bookshelf base. You can use 2" countersunk screws and glue or 3/4" PHs/1 1/4" PH screws and glue, but nails are not recommended because there is no face frame.

TIP: If using PHs you may wish to add the top (step 2) first to fit the drill in there, and then add middle shelf second.

STEP 2

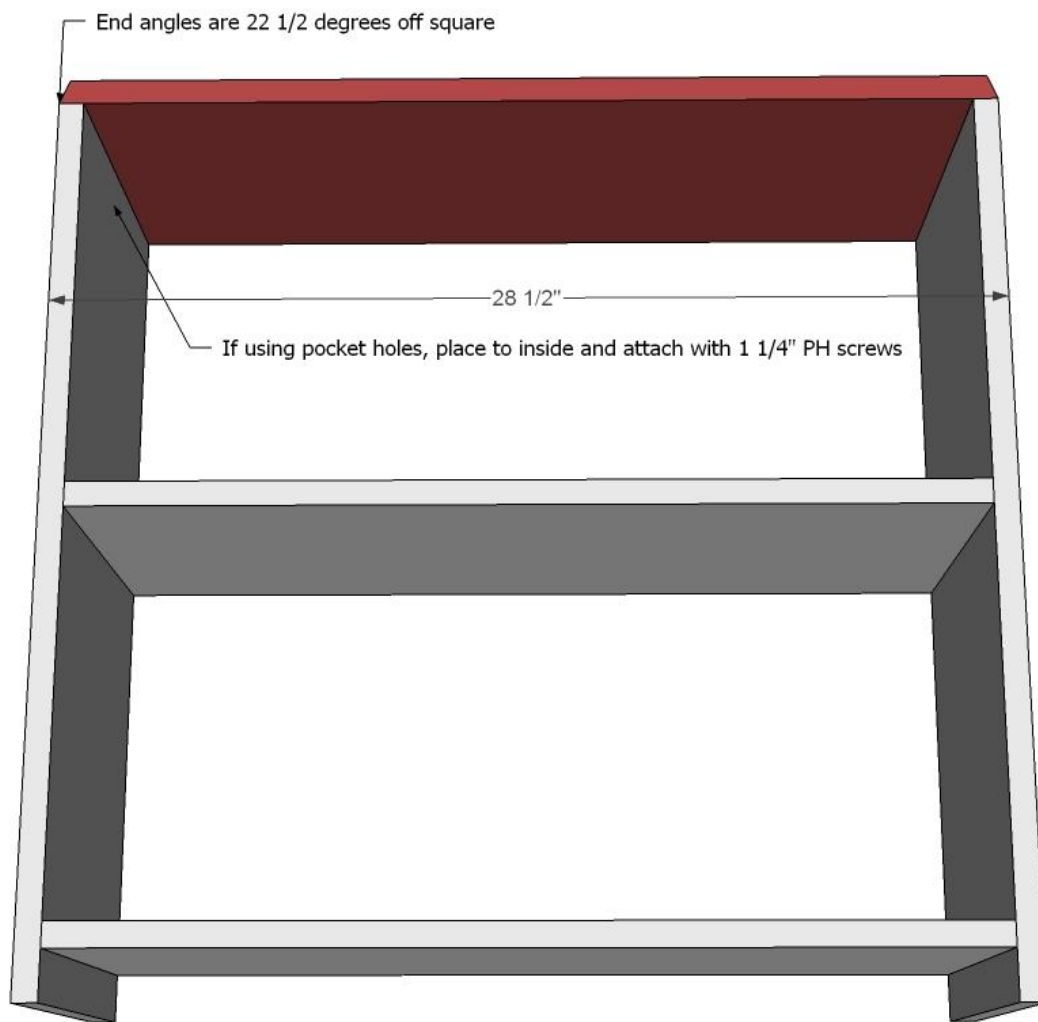

(/sites/default/files/3154817739_1353356808.jpg)

Now add the top.

STEP 3

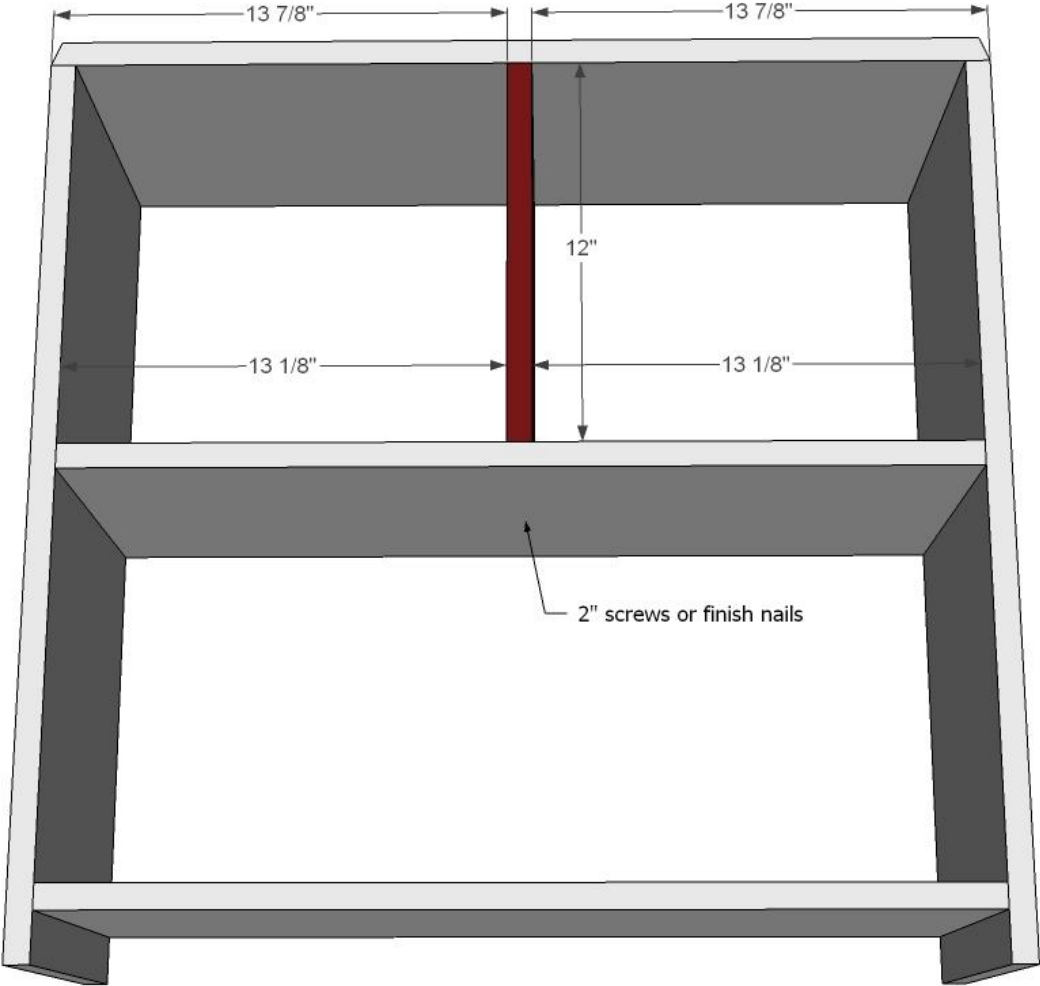

(/sites/default/files/3154817740_1353356808.jpg)
Now add the divider. You can just nail or screw this guy in.

STEP 4

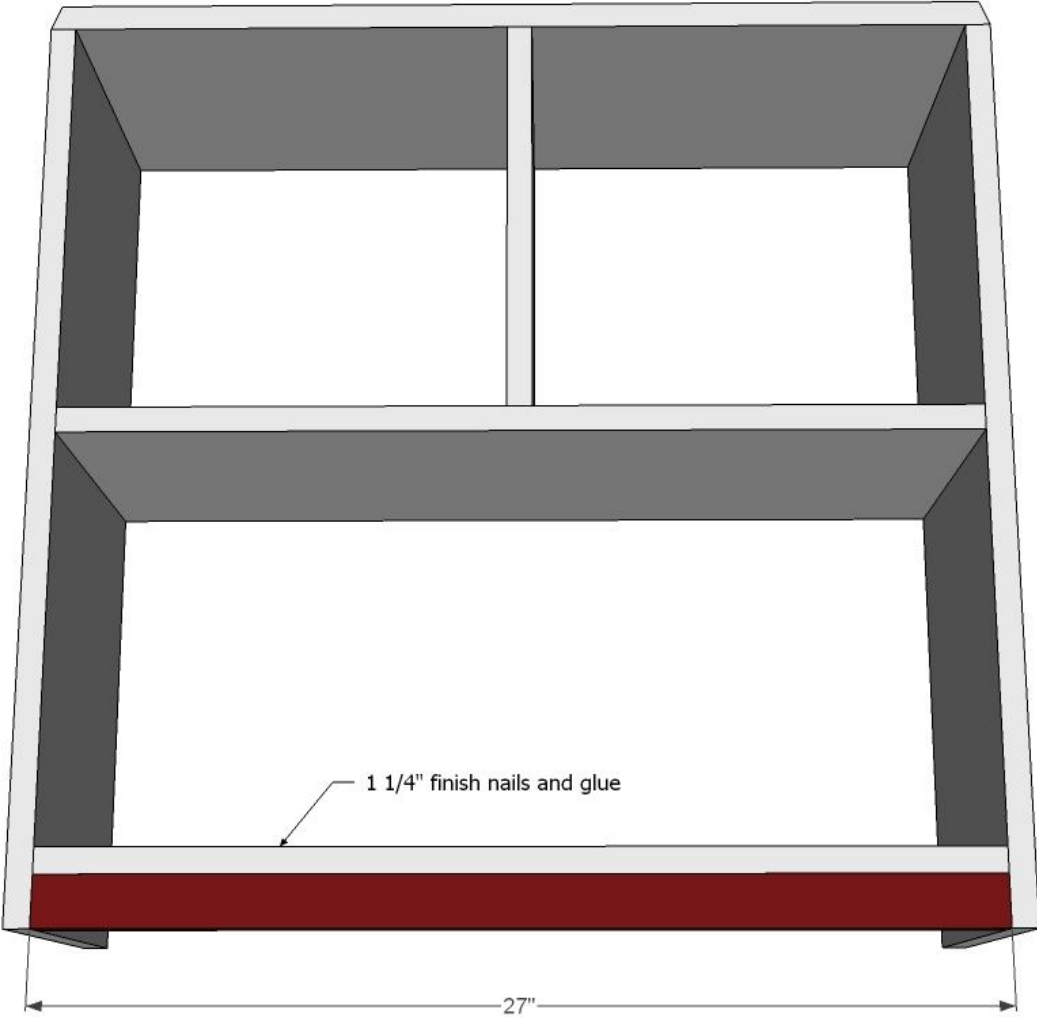

(/sites/default/files/3154817741_1353356808.jpg)
And the footer - glue and nails will do the trick here.

STEP 5

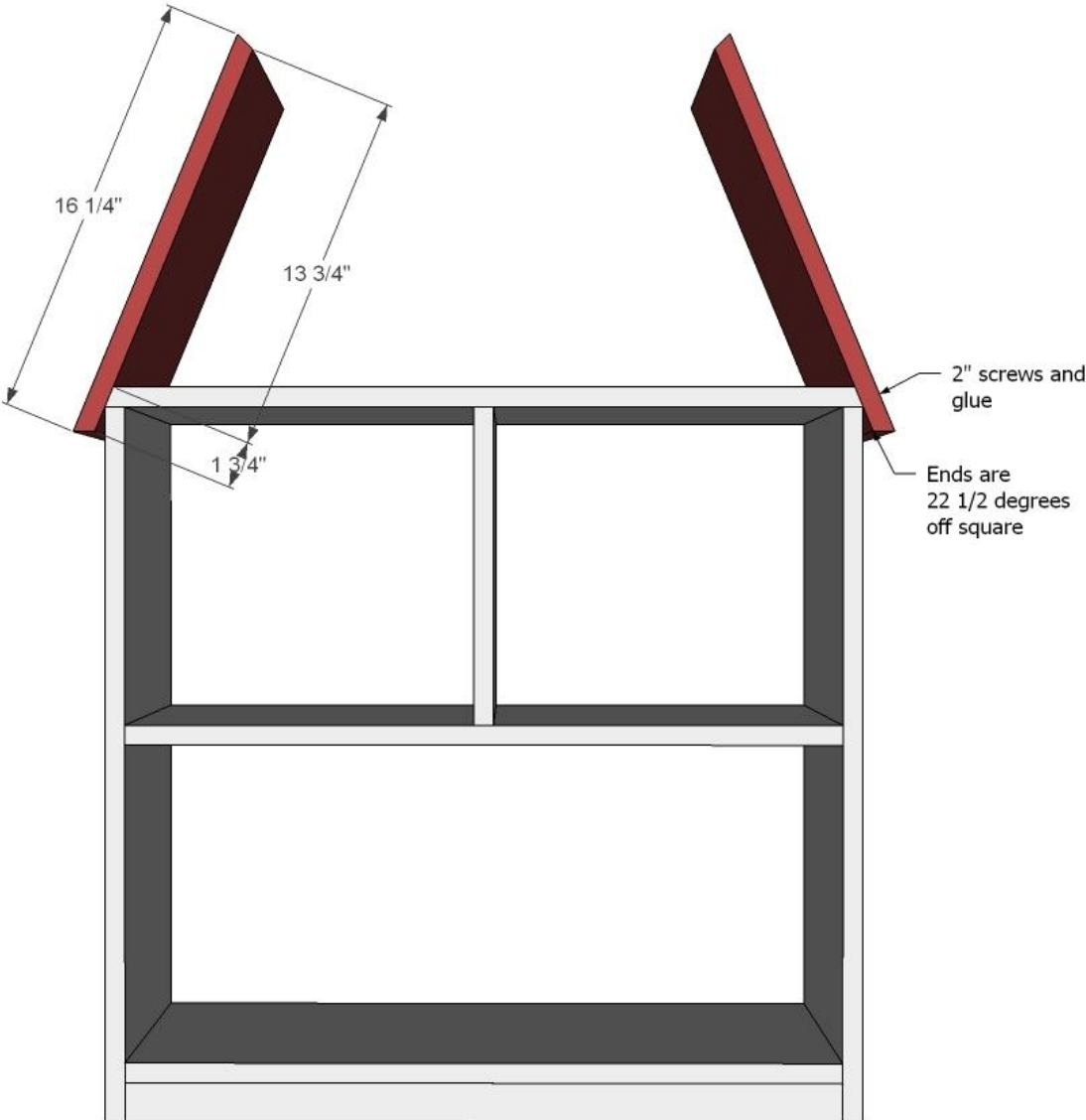

(/sites/default/files/3154817742_1353356808.jpg)

STEP 6

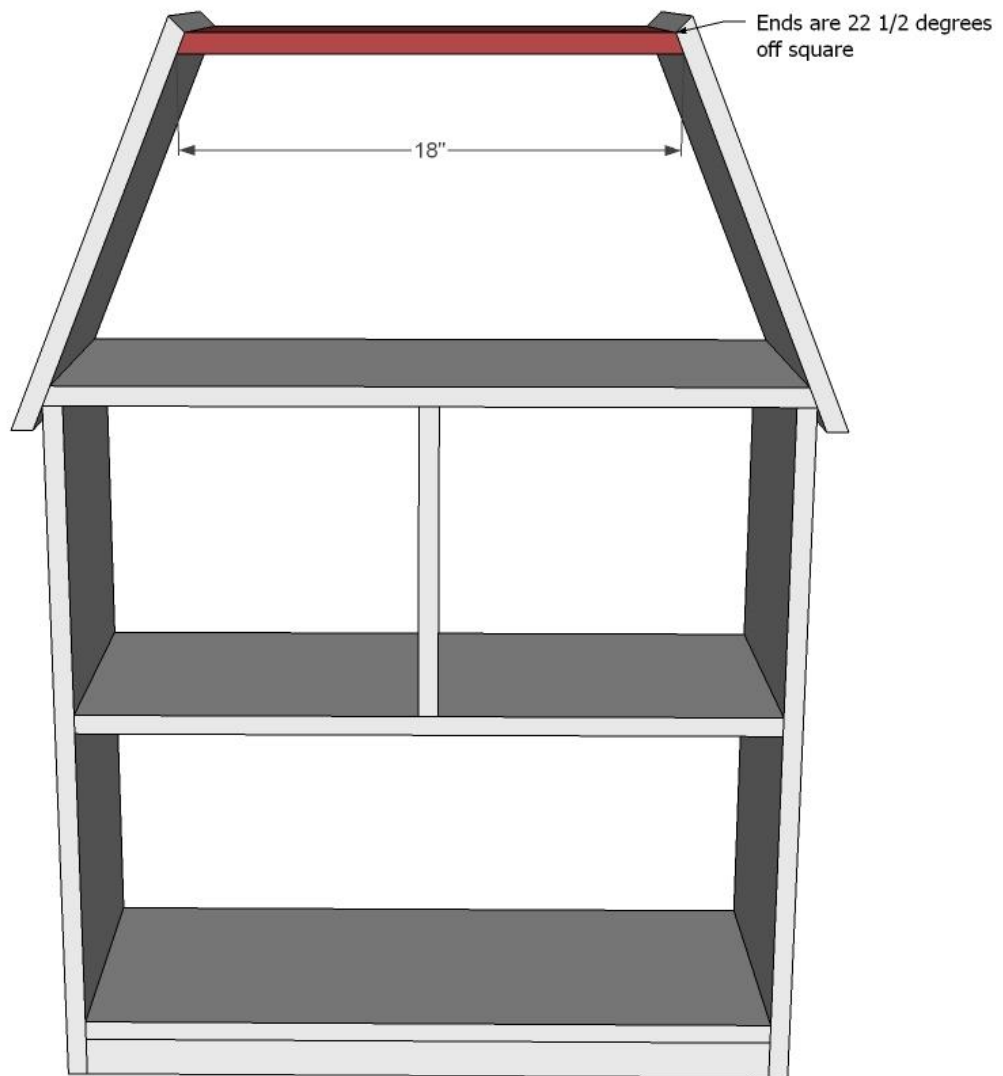

(/sites/default/files/3154817743_1353356808.jpg)

Now add the loft floor. Easiest way is 3/4" PHs and 1 1/4" PH screws from underside.

STEP 7

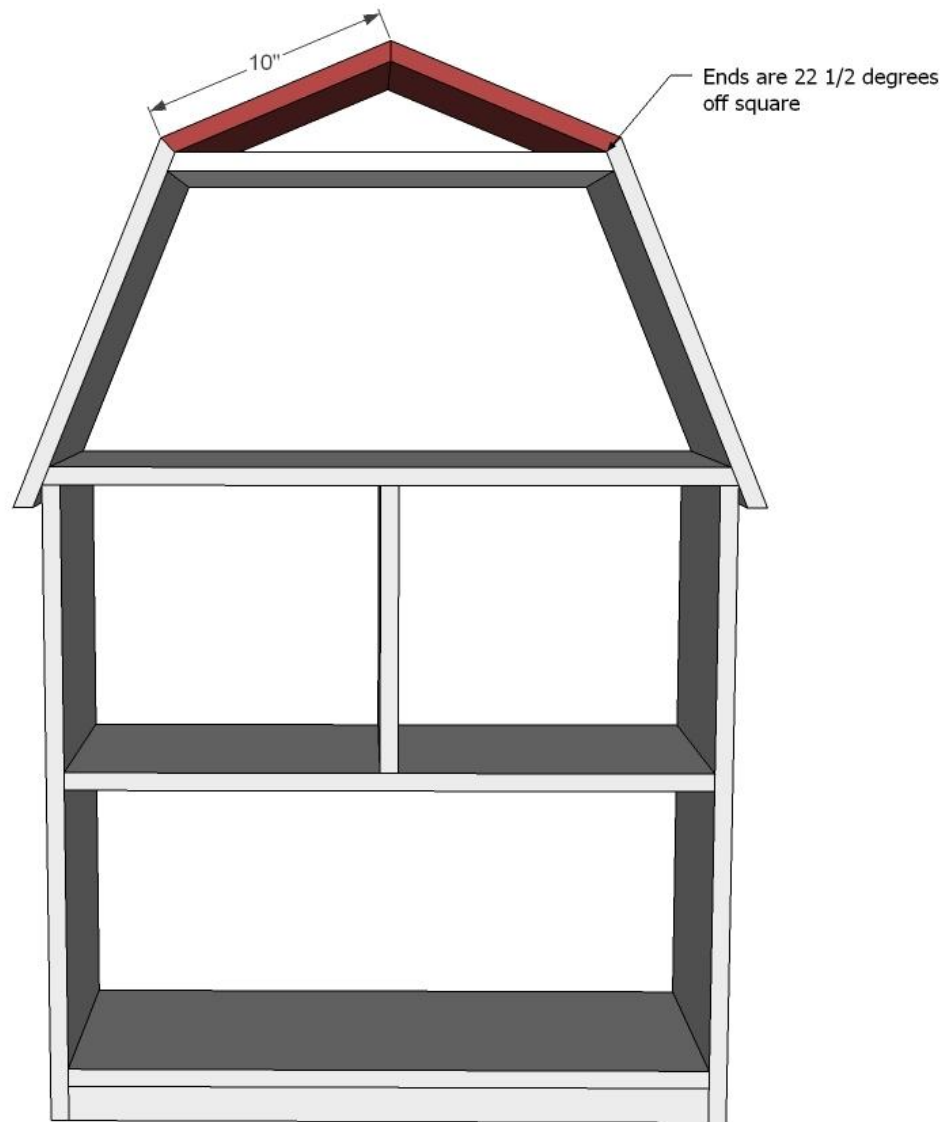

(/sites/default/files/3154817744_1353356808.jpg)

Glue and nail the remaining roof pieces in place. The next pieces will strengthen everything up.

STEP 8

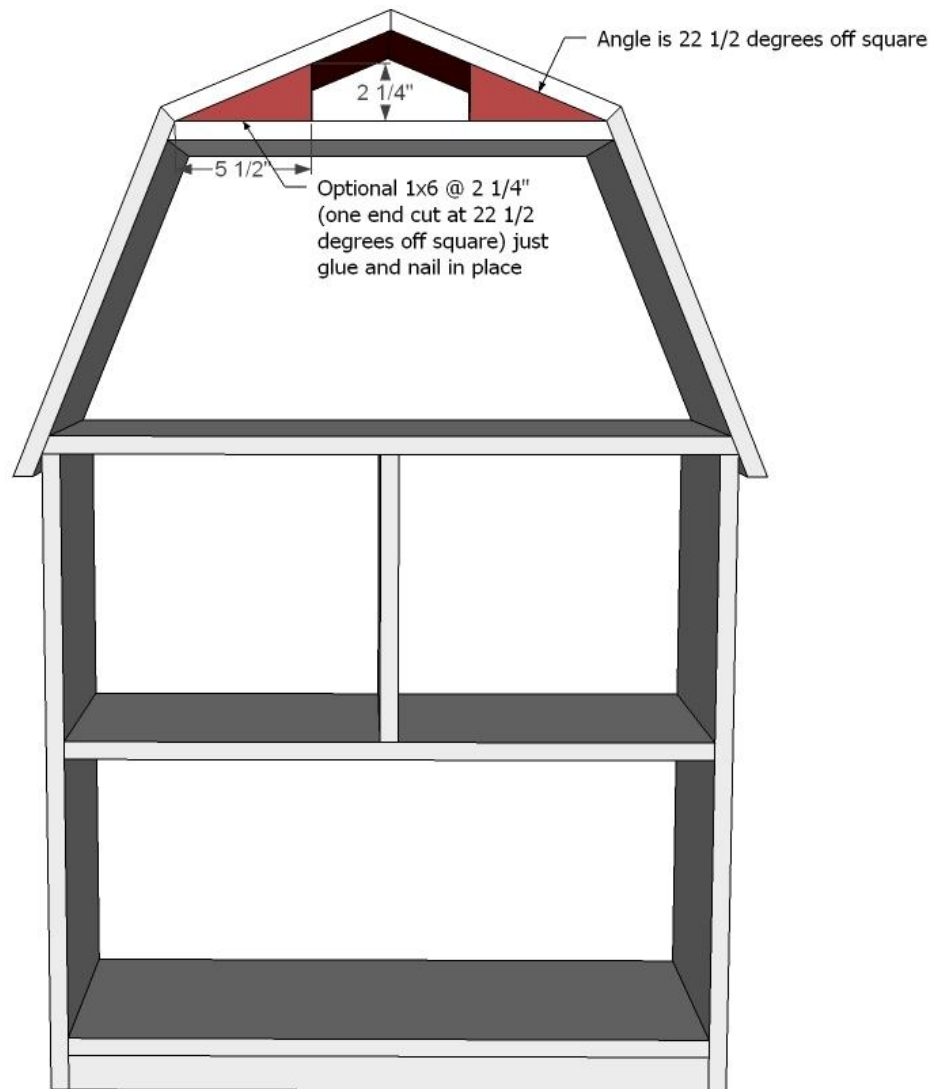

(/sites/default/files/3154817745_1353356808.jpg)

Add the roof pieces to secure top roof. Use glue and finish nails.

STEP 9

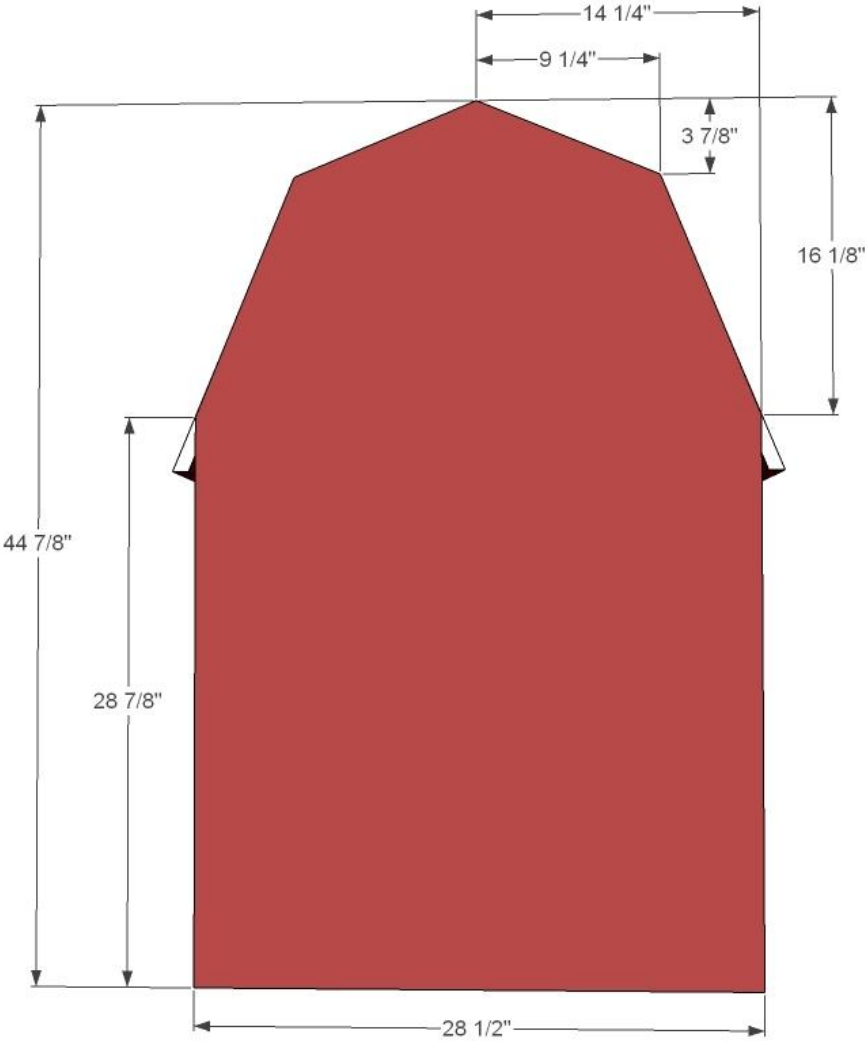

(/sites/default/files/3154817746_1353356808.jpg)

Finally, add the back to the entire project with 1 1/4" finish nails and glue.

STEP 10

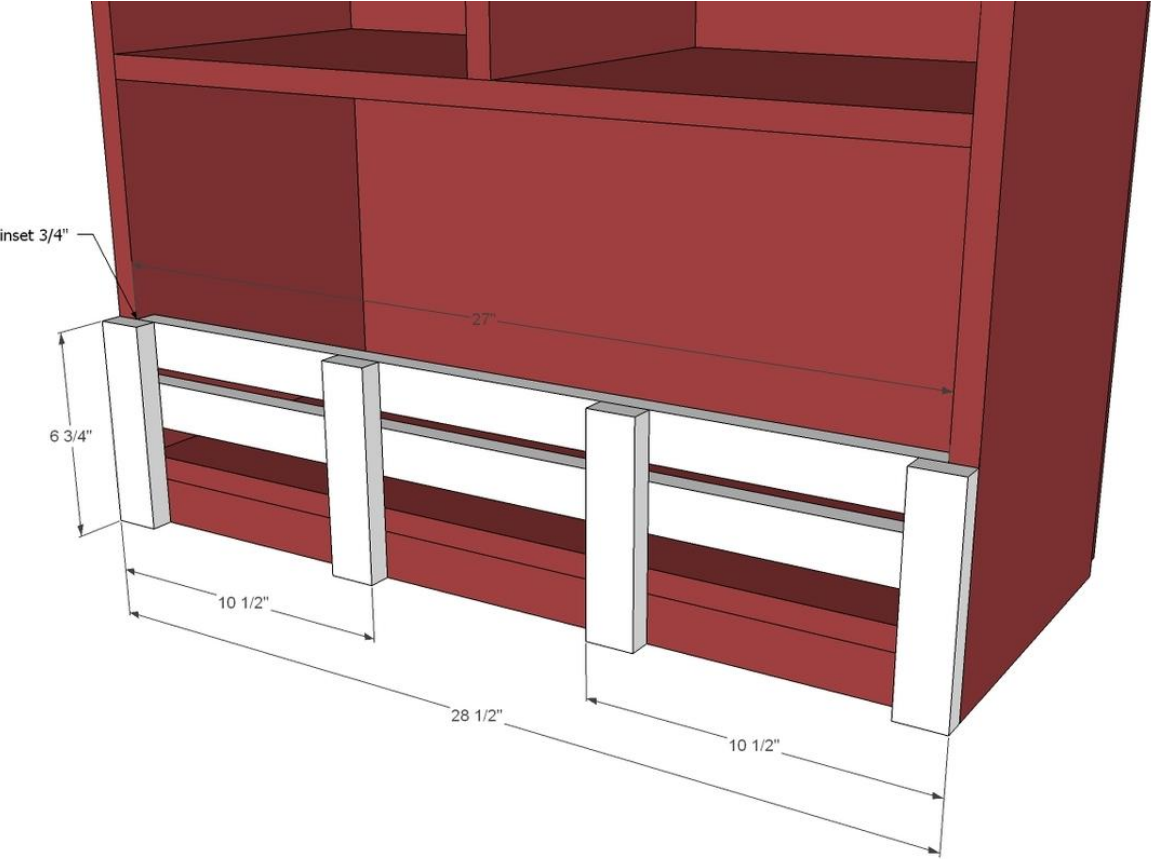

(/sites/default/files/3154817747_1353356808.jpg)

Finishing Instructions

Preparation Instructions: Fill all holes with wood filler and let dry. Apply additional coats of wood filler as needed. When wood filler is completely dry, sand the project in the direction of the wood grain with 120 grit sandpaper. Vacuum sanded project to remove sanding residue. Remove all sanding residue on work surfaces as well. Wipe project clean with damp cloth.

It is always recommended to apply a test coat on a hidden area or scrap piece to ensure color evenness and adhesion. Use primer or wood conditioner as needed.

Comments

Log in (</user/login?destination=/woodworking-projects/barn-shaped-bookshelf%23comment-form>) or register (</user/register?destination=/woodworking-projects/barn-shaped-bookshelf%23comment-form>) to post comments

Brag Posts from this Plan



(</community-projects/barn-bookshelf>)

Barn Bookshelf
(</community-projects/barn-bookshelf>)
By: nbivona (</users/nbivona>)



(</community-projects/revise-barn-bookshelf>)

Revised barn bookshelf
(</community-projects/revise-barn-bookshelf>)
By: North40 (</users/north40>)



(</community-projects/barn-tractor-supply-animals>)

Barn for Tractor Supply animals
(</community-projects/barn-tractor-supply-animals>)
By: jonbaty (</users/jonbaty>)



(</community-projects/baby-tel-barn-bookshelf>)



(</community-projects/john-deere-green-barn-shelf>)



(</community-projects/barn-dollhouse-0>)

Baby Teyla's barn bookshelf
(/community-projects/baby-teylas-barn-bookshelf)

By: Drew N Heidi 07
(/users/drew-n-heidi-07)

John Deere Green Barn
Shelf (/community-
projects/john-deere-green-
barn-shelf)

By: Veronica P (/users/veronica-
p)

Barn Dollhouse
(/community-projects/barn-
dollhouse-0)

By: harberbuilders
(/user/522883)



(/community-projects/doll-
house-barn-bookshelves-
fashion-dolls-and-books-lol)

Doll House & Barn /
bookshelves for fashion
dolls (and books LOL)
(/community-projects/doll-
house-barn-bookshelves-
fashion-dolls-and-books-lol)

By: Douglas Livingston
(/user/661131)

See All Brag Posts for this Project

Have You Built This Project? Add Your Brag Post!



(<https://www.ana-white.com/shareaphoto>)



Hello, I'm Ana White

I live in Alaska, where it's hard to find nice furniture. So I started building my own. I've been sharing my plans since 2009. I'm so glad you are here. Let's build something!



(<https://www.facebook.com/knockoffwood>)



(<https://www.pinterest.com/anawhitediy/>)



(<https://www.instagram.com/anawhitediy/>)



(<https://www.youtube.com/user/knockoffwood>)



(<https://twitter.com/anawhitediy>)

Get Plans Sent Direct to Your Email
(<https://anawhite.ck.page/4daf1e2af8>)